



The Gialamas Company, Inc.

1255 Fourier Drive - For Lease

Madison, WI

Exceptional Commercial Office Space

Sauk Trails Plaza II

- ◆ 160,000 SF Class A Commercial Development
- ◆ Finishes include Steel/Glass/Granite/Wood
- ◆ LED Lighting Fixtures
- ◆ High Efficiency VRF HVAC System
- ◆ Outdoor Patio Area/Walking Trails
- ◆ Access Card Regulated Security System
- ◆ Open and Bright Work Environment
- ◆ Free Ample Surface Parking
- ◆ Underground Parking Available
- ◆ 10' Ceilings with Floor to Ceiling Windows
- ◆ State of the Art Fitness Center
- ◆ Walking Distance to Restaurants, Hotels, Shopping
- ◆ Professionally Developed and Managed by The Gialamas Company

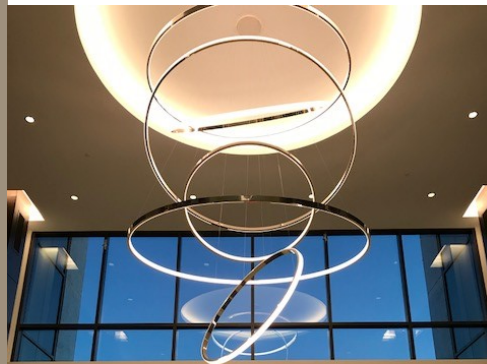
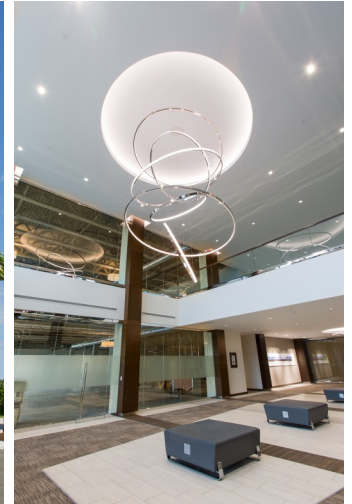

Please call
The Gialamas Company
at:
608-836-8000
to arrange a private tour



gialamas.com